



Argyle Road, W13

LONG LET. This bright one bedroom apartment is conveniently located next to the Elizabeth line and boasts a modern interior ideal for singles or couples.

- High Spec
- Walking distance to the Elizabeth Line
- Available in July 2026
- Great location for local amenities
- Early viewings advised
- Open plan living

£1,850 PCM

Flat 4 - Argyle Road

Approximate Gross Internal Area
377 sq ft - 35 sq m

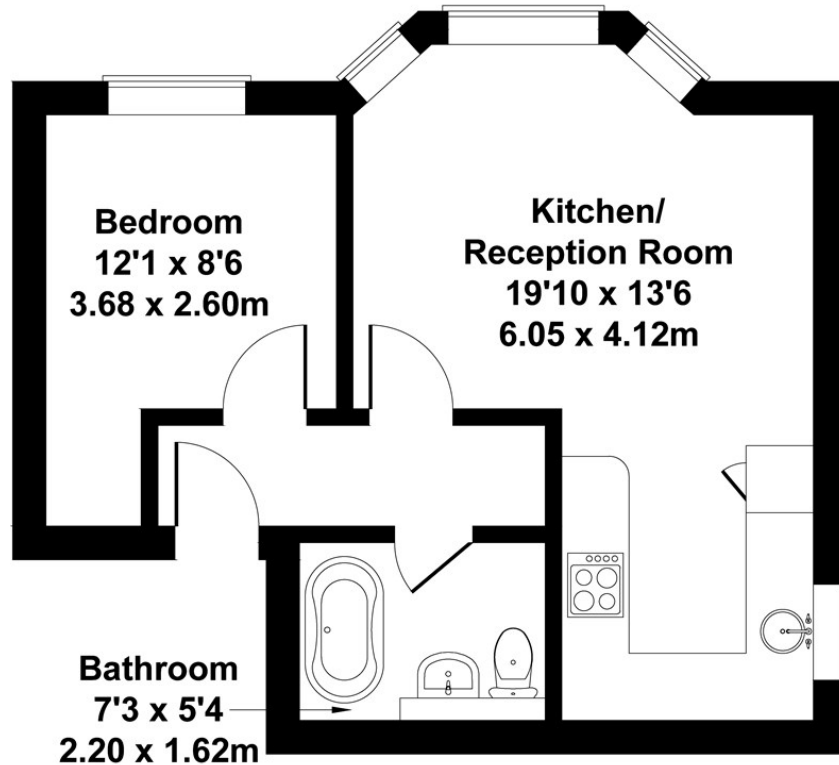
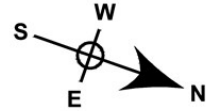

FIRST FLOOR

Not to Scale. Produced by The Plan Portal 2021
For Illustrative Purposes Only.

Energy Efficiency Rating		Current	Potential
<i>Very energy efficient - lower running costs</i>			
(92 plus) A			
(81-91) B			
(69-80) C			
(55-68) D			
(39-54) E			
(21-38) F			
(1-20) G			
<i>Not energy efficient - higher running costs</i>			
England & Wales	EU Directive 2002/91/EC		